

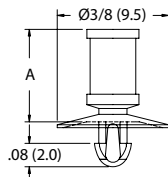

PUSH SPACER SUPPORT POSTS

CPST Series

Teardrop Push Spacer



Snap-Lock:
.100 ± .002 (2.5 ± 0.1)
Panel Thickness:
.062 (1.57) Max

Specifications:

- Material: Nylon 6/6
- Color: Natural
- Flame Class: UL94 V-2

Item No.	A		Bulk Pack Qty.
	In	mm	
CPST-2-01	0.125	3.2	1000
CPST-3-01	0.188	4.8	1000
CPST-4-01	0.250	6.4	1000
CPST-5-01	0.313	7.9	1000
CPST-6-01	0.375	9.5	1000
CPST-7-01	0.438	11.1	1000
CPST-8-01	0.500	12.7	1000
CPST-9-01	0.563	14.3	1000
CPST-10-01	0.625	15.9	1000

CBPSW Series

Wide Base Push Spacers



To Lock in Hole:
.137 (3.5)
Panel Thickness:
.047-.067 (1.2-1.7)

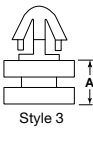
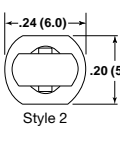
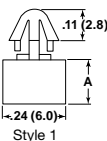

Specifications:

- Material: Nylon 6/6
- Color: Natural
- Flame Class: UL94 V-2

Features:

- The wide base design on both ends provides additional support for heavily loaded PCBs.
- Eliminates screws, nuts and lock washers from mounting

Item No.	A		Style	Bulk Pack Qty.
	In	mm		
CBPSW005A	0.118	3.0	1	2000
CBPSW010A	0.138	3.5	1	2000
CBPSW015A	0.157	4.0	1	2000
CBPSW020A	0.177	4.5	2	2000
CBPSW025A	0.197	5.0	3	2000
CBPSW030A	0.217	5.5	2	2000

Item No.	A		Style	Bulk Pack Qty.
	In	mm		
CBPSW035A	0.236	6.0	2	2000
CBPSW040A	0.256	6.5	2	2000
CBPSW045A	0.276	7.0	2	2000
CBPSW050A	0.531	13.5	2	2000
CBPSW055A	1.024	26.0	2	2000

PSM

Mini Push Spacer

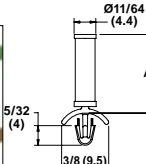

- Supports heavily loaded PC boards
- Often used with Richco LCBS series
- Material: UL94 V-2 Nylon 6/6
- Color: Natural

Item No.	A	Bulk Pack Qty.
PSM-2-01	1/8 (3.2)	1000
PSM-3-01	3/16 (4.8)	1000
PSM-4-01	1/4 (6.4)	1000
PSM-5-01	5/16 (7.9)	1000
PSM-6-01	3/8 (9.5)	1000
PSM-7-01	7/16 (11.1)	1000

Item No.	A	Bulk Pack Qty.
PSM-8-01	1/2 (12.7)	1000
PSM-9-01	9/16 (14.3)	1000
PSM-10-01	5/8 (15.9)	1000

PSD

Metric Push Spacer

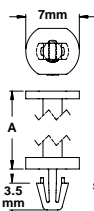

- Sturdy construction supports heavily loaded PCB's
- Allows easy access to underside of board
- Material: Nylon 6/6
- Color: Natural

Item No.	A		Bulk Pack Qty.
	In	mm	
Material: UL94 V-2			
PSD-4M-01		4	1000
PSD-6M-01		6	1000
PSD-7M-01		7	1000
PSD-8M-01		8	1000
PSD-10M-01		10	1000
PSD-12M-01		12	1000
PSD-14M-01		14	1000
PSD-16M-01		16	1000
Material: UL94 V-0			
PSD-4M-19		4	1000
PSD-6M-19		6	1000
PSD-7M-19		7	1000
PSD-8M-19		8	1000
PSD-10M-19		10	1000
PSD-12M-19		12	1000
PSD-14M-19		14	1000
PSD-16M-19		16	1000

CBPS

Push In Spacers



To Lock in Hole:
.118 (3.0)
Panel Thickness:
.031-.078 (0.8-2.0)

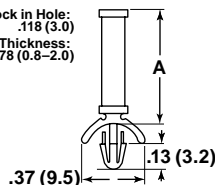

Specifications:

- Material: Nylon 6/6
- Color: Natural
- Flame Class: UL94 V-2

Features:

- The tension wing design offers extra support and a secure fit
- No fasteners required for mounting due to the one-piece design

Item No.	A		Bulk Pack Qty.	Item No.	A		Bulk Pack Qty.
	In	mm			In	mm	
CBPS105A	0.125	3.2	1000	CBPS130A	0.437	11.1	1000
CBPS110A	0.187	4.8	1000	CBPS135A	0.500	12.7	1000
CBPS115A	0.250	6.4	1000	CBPS140A	0.562	14.3	1000
CBPS120A	0.312	7.9	1000	CBPS145A	0.625	15.9	1000
CBPS125A	0.375	9.5	1000	CBPS150A	0.748	19.0	1000

PST Series

Teardrop Push Spacer

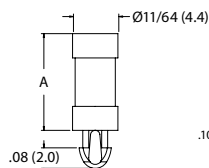

Specifications:

- Material: Nylon 6/6
- Color: Natural
- Flame Class: UL94 V-2

Item No.	A		Bulk Pack Qty.
	In	mm	
PST-1-01	0.063	1.6	1000
PST-2-01	0.125	3.2	1000
PST-3-01	0.188	4.8	1000
PST-4-01	0.250	6.4	1000
PST-5-01	0.313	7.9	1000

Item No.	A		Bulk Pack Qty.
	In	mm	
PST-6-01	0.375	9.5	1000
PST-7-01	0.438	11.1	1000
PST-8-01	0.500	12.7	1000
PST-9-01	0.563	14.3	1000
PST-10-01	0.625	15.9	1000